



One The Elephant

1 St Gabriel Walk, SE1 6FB

Asking Price £560,000



Floor Plan

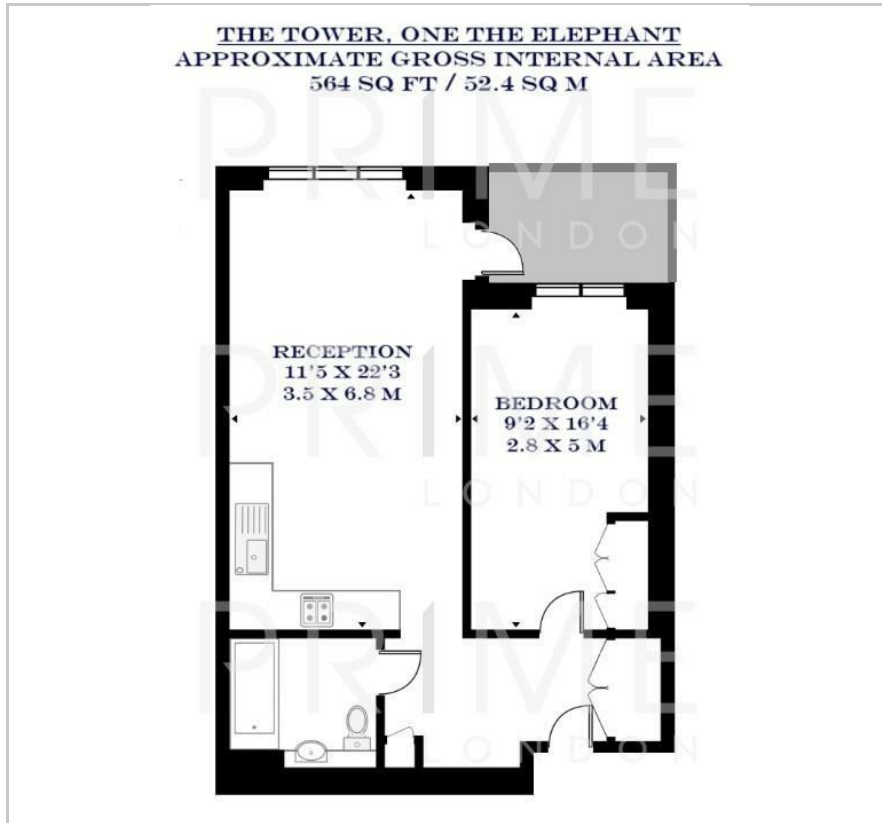

Area Map

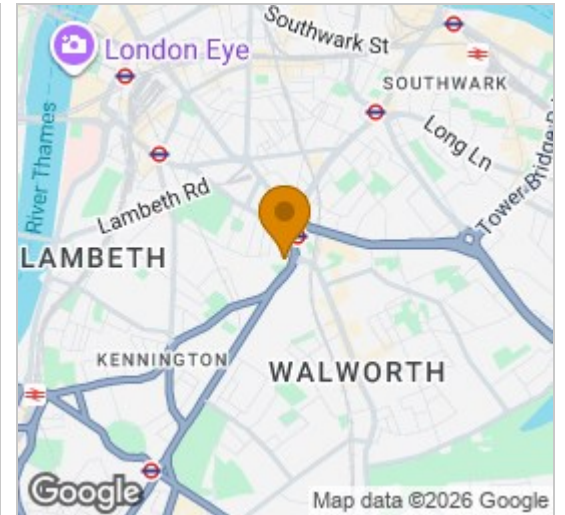

Energy Efficiency Graph



Viewing

By appointment. Contact us on 0207 928 6663 if you wish to arrange a viewing appointment for this property, or require further information.

- One bedroom apartment
- 564 sq ft (52.4 sqm)
- Offering skyline views
- Residents' lounge, gym, pool and green roof
- Just 0.2 miles to Elephant and Castle Station
- 24 hour concierge



This stunning high floor one bedroom apartment, perfectly situated within the highly sought-after One The Elephant development, is available for sale through Prime London.

Totalling 564 sq ft (52.4 sqm), this property offers a spacious open-plan living and dining area that leads on to a modern kitchen, thoughtfully designed with integrated appliances.

The bedroom is complete with built-in storage that maximizes space without compromising on aesthetics, as well as a stylish bathroom suite, featuring contemporary fittings. The property also features a private balcony, the perfect spot to unwind and enjoy the surrounding views.

Residents of One The Elephant enjoy an array of exclusive amenities, including a 24 hour concierge, a beautifully designed residents' lounge, a 'green roof', pool, gym, and a café.

The vibrant Elephant and Castle neighborhood boasts a rich selection of bars, restaurants, and essential amenities, with a brand-new shopping district currently under construction.

Conveniently located near Elephant and Castle station, this property offers excellent transport links with both Underground and rail services.



These particulars, whilst believed to be accurate are set out as a general outline only for guidance and do not constitute any part of an offer or contract. Intending purchasers should not rely on them as statements of representation of fact, but must satisfy themselves by inspection or otherwise as to their accuracy. No person in this firm's employment has the authority to make or give any representation or warranty in respect of the property.